

Technical Specifications

Power	AC 120V 60Hz	AC 230/240/250V 50/60Hz
Fuse	6X30mm Glass T15A	
Lamps	J Type 120V 300W	J Type 230V 500W
Dimension	360mm x 225mm x 150mm(i Color-3) 450mm x 270mm x 175mm(i Color -4)	
Weight	6 kg / 13.2 lbs(i Color -3) 7 kg / 15.4lbs(i Color -4)	

Intelligent Lighting

Professional Lighting Technology

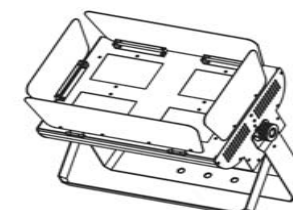
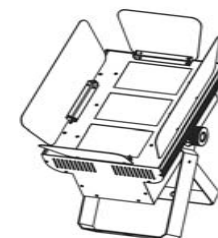

***i*Color 3**

***i*Color 4**

User Guide

Please read these instructions carefully before use

Built for the best performance !

=====

For further requirements, contact the nearest authorized technical assistance office

=====

7. Fixture Cleaning

The cleaning of internal and external optical lenses and/or mirrors must be carried out periodically to optimize light output. Cleaning frequency depends on the environment in which the fixture operates: damp, smoky or particularly dirty surrounding can cause greater accumulation of dirt on the unit's optics.

- * Clean with soft cloth using normal glass cleaning products.
- * Always dry the parts carefully.
- * Clean the external optics at least once every 20 days. Clean the internal optics at least every 30/60 days.

2B

EC Declaration of Conformity

We declare that our products (lighting equipments) comply with the following specification and bears CE mark in accordance with the provision of the Electromagnetic Compatibility (EMC) Directive 89/336/EEC.

EN55014-1: 1993, EN61000-3-2: 1995, EN61000-3-3:1995

EN55014-2: 1997 CATEGORY II

EN61000-4-2: 1995, EN61000-4-3: 1995, EN61000-4-4:1995

EN61000-4-5: 1995, EN61000-4-6: 1995, EN61000-4-11: 1994

&

Harmonized Standard

EN60598-1: 1993

Safety of household and similar electrical appliances

Part 1 : General requirements

Following the provisions of the Low Voltage Directive 73/23/EEC and 93/68/EEC.

EC Declaration of Conformity

We declare that our products (remote controller) comply with the following specification and bears CE mark in accordance with the provision of the Electromagnetic Compatibility (EMC) Directive 89/336/EEC.

EN55015: 1993

EN50082-1: 1997

EN61000-3-2: 1995

EN61000-3-3: 1995

6. Troubleshooting

Following are a few common problems that may occur and suggestions as to how to solve them.

A. No light

1. Check the power on LED and fuse
2. Check the lamp if it is ok? (The lamp may turn off, when the unit is in blackout).

B. Not responding to DMX

1. Check red LED is on, if not, check DMX connectors, cables and linking correctly.
2. If the red LED is on and no response to the channel, check the dipswitch settings and DMX polarity.
3. If you have intermittent DMX signal problems, check the pins on connectors or on PCB of the unit or the previous one.
4. Try to use another DMX controller.
5. Check if the DMX cables run near or run alongside to high voltage cables that may caused damage or interference to DMX interface circuit.

C. Some units don't respond to the controller

You may have a break in the DMX cabling. The unit receiving no DMX signal will begin its own light show. Check the red LED for the response of the DMX signal.

D. No response to the sound

1. Check the unit that is not receiving DMX signal (red LED should be off)
2. Check the unit that is not set to display mode
3. Check microphone to see if it is good by tapping the microphone

INDEX

1. General Instructions
2. Main Features
3. Lamp
4. DMX Linking & Controls
5. How To Control The Unit
 - A. By master/slave function
 - B. By easy controller
 - C. By Colormix controller
 - D. By universal DMX controller
6. Troubleshooting
7. Fixture Cleaning

1. Getting Started

The following points are important for safety as well as for the smooth installation and performance of the unit.

- Unpack carefully and be sure that no damage has occurred during shipping.
- It is very important to ground the yellow/green conductor in order to meet regulations for safety.
- Do not connect the device to any dimmer pack.
- The electrical work that is necessary for installation must do by qualified personnel.
- Be sure to locate the unit in a place with adequate ventilation at least 15 cm from the walls and at least 100 cm from adjacent surfaces. Be sure than no ventilation slots are blocked.
- Be careful that no liquids or other objects can enter the unit. If this ever happens, disconnect the main power immediately.
- In the event of serious operating problems, turn off the unit immediately. Never try to repair the unit yourself. Repairs carried out by non-qualified personnel can lead to serious damage or malfunction. Please contact your dealer about authorized technical assistance. Always use genuine spare parts.
- Occasional breaks are necessary to prevent breakdowns. This unit is not designed to be used non-stop.
- Always remember to unplug the unit from the power mains before any service is done.
- Please recycle the packaging.

D. By universal DMX controller

If you use a universal DMX controller to control the units, you have to set dip switches from 1 to 9 of the channel so that all the units will receive its DMX signal. Please refer to the following diagram to know how to address your DMX512 system in the binary code.

DMX512 Address Chart

Dip	#1	#2	#3	#4	#5	#6	#7	#8	#9	#10
Value	1	2	4	8	16	32	64	128	256	M/S





- Examples:

Channel 1 : dip / on : #1 (1)

Channel 5 : dip / on : #1, #3 (1 + 4 = 5)

Channel 9 : dip / on : #1, #4 (1 + 8 = 9)

Channel 13 : dip / on : #1, #3, #4 (1 + 4 + 8 = 13)

Channel	Dipswitches setting
1	↓  ON 1 2 3 4 5 6 7 8 9 10
5	↓  ON 1 2 3 4 5 6 7 8 9 10
9	↓  ON 1 2 3 4 5 6 7 8 9 10
13	↓  ON 1 2 3 4 5 6 7 8 9 10

- DMX512 Configuration

4B

DMX512 Configuration			
CH1	CH2	CH3	CH4
Color	Chase	Speed	Master
255 Color Chase	255 Y-G	255 Fast	0%
240 Color Fade	232 R-G		
224 Color32	211 Y-B		
217 Color31	190 B-R		
210 Color30	169 G-BR		
203 Color29	148 R-GB		
196 Color28	127 Dynamic Chase		
189 Color27	106 Spectrum Sequence Chase		
182 Color26	85 Spectrum Random Chase		
175 Color25	64 Mood Chase(P\B\G\I\l-R)		
168 Color24	43 Bright Chase(R\Y\O\l\C)		
161 Color23	22 Standard Chase (R\G\Y\l\B)		
154 Color22	0	0 Slow	100%
147 Color21			
140 Color20			
133 Color19			
126 Color18			
119 Color17			
112 Color16			
105 Color15			
98 Color14			
91 Color13			
84 Color12			
77 Color11			
70 Color10			
63 Color9			
56 Color8			
49 Color7			
42 Color6			
35 Color5			
28 Color4			
21 Color3			
14 Color2			
7 Color1			
0			

C. By Colormix controller

By link the Colormix controller to the unit, you have to use 3 pin XLR cable and use 5 pin XLR cable between Colormix controller and Colormix foot controller.

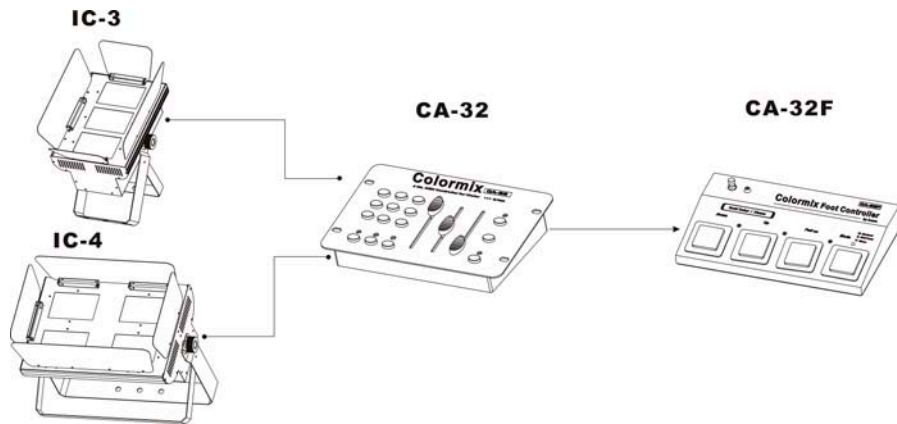

CA-32

- A professional, user friendly DMX 4ch.controller for colorimixing.
- Equipped with 9 different hold-color buttons for instant access of colors.
- Comes with 32 spectrum mix colors, color fade, and 12 different chase patterns,
- Providing the richest changing colors for the show.
- Speed and dimmer adjustable for both color fade and chase.
- Sound activated function is available.
- Full on and Blackout functions.

CA-32F

- Colormix Foot controller is a extended controller of Colormix.
- To be liked with Colormix. Add a switch to change the control between Colormix and Colormix Foot Controller.
- Mode i.) Blackout (LED on)
 - ii.) Hold Color(LED off)
 - iii.) Chase (LED blinking)-Stamp on the button over 2 seconds for chase
- Up and Down buttons:To select the hold colors and chase patterns.
- Full on:Stamp the button for full on.

2. Main Features

Voltage : AC 120V 60Hz or 230/240/250V 50/60 Hz

- Bulb : J Type 230V 500W(Euro)
J Type 120V 300W(USA)
- 3 dichroic mirrors red, blue, and green or 4 dichroic mirrors red, yellow, blue, and green.
- With lamp saving switch-off function. When the unit receives stand by signal from a easy controller or an universal DMX controller, it will switch off the lamp extending the lamp's lifetime.
- Easy door to bulb change lamp.
- Standard DMX-512 control and address. By DMX linking and XLR cable.
- This units can be linked together in a master/slave combination and run by built-in programs.
- Compatible with easy controller or universal DMX controller.
- DMX signal / sound activation indication LED.
- Efficient axial fan cooling.
- Dimension : 360 x 225 x 150mm (i Color-3)
450 x 270 x 175mm (i Color-4)
- Weight : 6 kg (i Color-3) / 7 kg (i Color-4)

5B

3. Lamp

J Type 230V 500W(Euro)

J Type 120V 300W(USA)

- Always switch off the mains supply and never handle the lamp or luminaire when it is hot.
- Do not touch the bulb with bare hands. If this does happen, clean the lamp with denatured alcohol and wipe with a lint free cloth before installing.

4. DMX Link & Controls

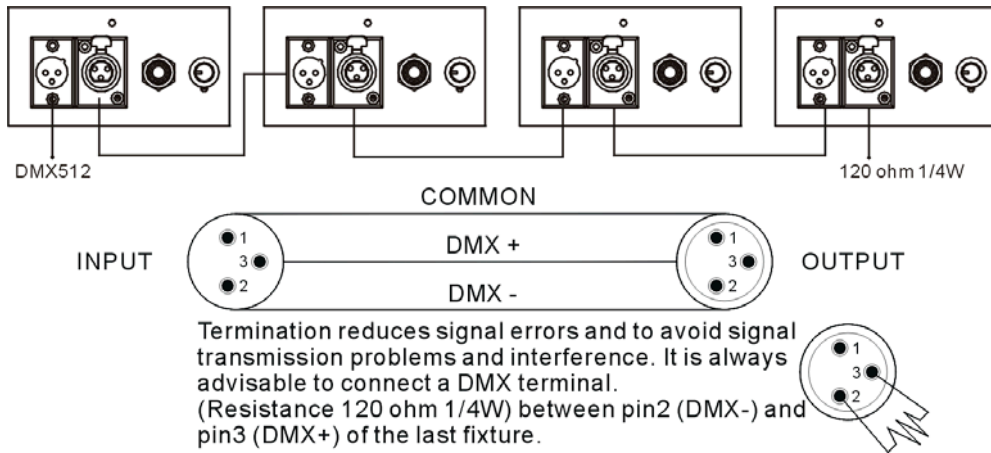

- 1. DMX output:** pin 1: Comm., pin 2: DMX-, pin 3: DMX+.
- 2. DMX input:** pin 1: comm., pin 2: DMX-, pin 3: DMX+. If you are using a controller with 5 pins DMX output, you will need to use a 5 to 3 pin adapter.
- 3. Dipswitch:** Dipswitch 1-9 set the DMX channel that the unit will respond to. Channel 1 is the start address. Switch 10 sets the master/slave in 'group' of all the units. Please refer to the diagram on setting the dipswitches.
- 4. Red LED: DMX signal / Sound activation.** This LED will flash when DMX signal is being received or sound activation is working.
- 5. Built-in microphone for sound activation.**

Connect the unit together in a 'daisy chain' by XLR plug from the output of the unit to the input of the next unit. The cable can not be branched or split to a 'Y' cable. DMX512 is a very high-speed signal. Inadequate or damaged cables solder joints or corroded connectors can easily distort the signal and shut down the system.

5. How To Control The Unit

You can operate the unit in four ways:

A. By master/slave preprogrammed function

By linking the units in master/slave connection, the first unit will control the other units to give an automatic activated synchronized light show. In this mode, the first unit (master) dipswitch 10 must be on.

This function is good when you want an instant show. You will know which unit is the master because its DMX input jack will have nothing plugged into it and its red LED will flash to the music. The other units (slaves) will have DMX cables plugged into the DMX input jacks (daisy chain) and the red LED lights will be constantly flashing. Please refer to the diagram on setting the dipswitches.

Channel	Dip switches setting
Master	↓ ON 1 2 3 4 5 6 7 8 9 10
Slave 1	↓ ON 1 2 3 4 5 6 7 8 9 10
Slave 2	↓ ON 1 2 3 4 5 6 7 8 9 10
Slave 3	↓ ON 1 2 3 4 5 6 7 8 9 10

B. By easy controller(CA-8 & CA-8F)

The easy remote control is used only in master/slave mode. By connecting to the 1/4" microphone jack of the first unit, you will find that the remote control on the first unit will control all the other units for Stand by, Function/Mode.

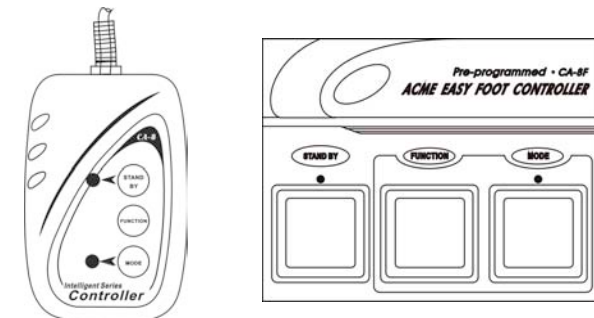

Stand By	Blackout the unit		
Function	1. Synchronous Strobe 2. 2-light Show Strobe	Full on/Color select	Dimmer
Mode	Sound	Manual	Latch