

# LS-RGB-DMX CONTROL

# LS-WH-DMX CONTROL



## ENGLISH

### Operation Manual



*Version: 1.0*



# CONTENTS

Warning -----	1
Caution -----	1
Getting Ready -----	2
Description -----	2
Electrical Instructions -----	3
How to set the DMX addresses: -----	4
Operating instructions -----	6
16 - Section switch table -----	7
Product Specifications -----	9

*If the supply cord is damaged, it must be replaced by the manufacturer, its service agent or similarly qualified persons in order to avoid a hazard.*



Read the manual



IP44

**IP44**



This symbol indicating separate collection for electrical and electronic equipment

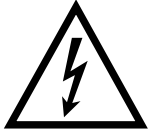

## Warning!



- To prevent fire or shock hazard, do not expose this appliance to rain or moisture.
- To avoid condensation to be formed inside, allow the unit to adapt to the surrounding temperatures when bringing it into a warm room after transport. Condense sometimes prevents the unit from working at full performance or may even cause damages.
- Don't place metal objects or spill liquid inside the unit. No objects filled with liquids, such as vases, shall be placed on this appliance. Electric shock or malfunction may result. If a foreign object enters the unit, immediately disconnect the mains power.
- No naked flame sources, such as lighted candles, should be placed on the appliance.
- Don't cover any ventilation openings as this may result in overheating.
- Prevent use in dusty environments and clean the unit regularly.
- Keep the unit away from children.
- Inexperienced persons should not operate this device.
- Maximum save ambient temperature is 40. Don't use this unit at higher ambient temperatures.
- Always unplug the unit when it is not used for a longer time or before you start servicing.
- The electrical installation should be carried out by qualified personal only, according to the regulations for electrical and mechanical safety in your country.
- Check that the available voltage is not higher than the one stated on the rear panel of the unit.
- The socket inlet shall remain operable for disconnection from the mains.
- The power cored should always be in perfect condition. Switch the unit immediately off when the power cord is squashed or damaged. It must be replaced by the manufacturer, its service agent or similarly qualified persons in order to avoid a hazard.
- Never let the power-cord come into contact with other cables!
- In order to prevent electric shock, do not open the cover. Apart from the mains fuse there are no user serviceable parts inside.
- In the event of serious operating problems, stop using the appliance and contact your dealer immediately.
- Please use the original packing when the device is to be transported.
- Due to safety reasons it is prohibited to make unauthorized modifications to the unit.

## Caution!



To reduce the risk of electric shock, do not remove the top cover. No user-serviceable parts inside. Refer servicing to qualified service personnel only.

## Getting Ready

All products are thoroughly tested at the factory and shipped in perfect condition. If damage has occurred during shipping, or if components are missing, please contact your local dealer immediately.

### Inside the Package

- One LED String Controller (LS-RGB-DMX or LS-WH-DMX, 3A power supply included)
- Operating instructions

## Description

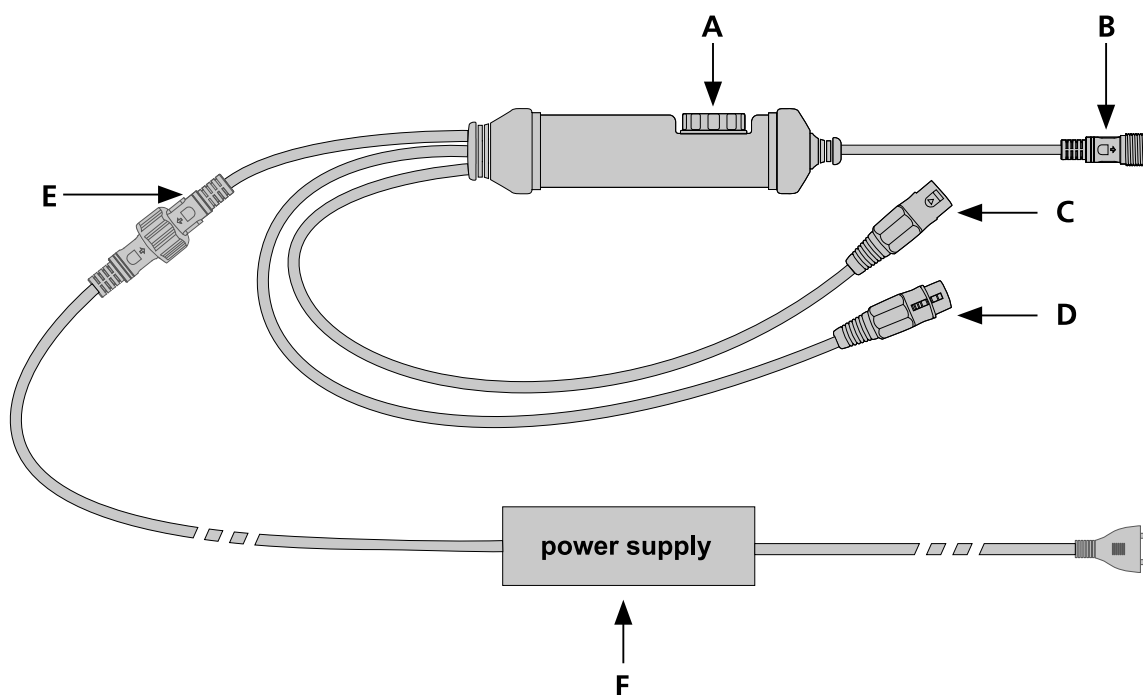

- A.** "16-section" turntable & LED indicator
- B.** 5 PIN JY connector
- C.** 3 PIN XLR connector (DMX IN)
- D.** 3 PIN XLR connector (DMX OUT)
- E.** 2 PIN power connector
- F.** Additional Power Supply

# Electrical Installation



Important: The electrical installation should be carried out by qualified personal only, according to the regulations for electrical and mechanical safety in your country.

## Electrical installation for 1 standalone unit:

- Just insert the mains cable. Switch the "16-section" turntable (A) on the LED String Controller (LS-RGB-DMX or LS-WH-DMX) from 1~F (except "0"), the unit starts working immediately in stand-alone mode.

## Electrical installation for two or more units in DMX-mode:

- The DMX-protocol is a widely used high speed signal to control intelligent equipment. You need to "daisy chain" your DMX controller and all the connected units with DMX cable.
- To prevent strange behavior of the light effects, due to interferences, you must use a  $90\Omega$  to  $120\Omega$  terminator at the end of the chain. Never use Y-splitter cables, this simply won't work!
- Make sure that all units are connected to the mains.
- Done!

Each LED String Controller in the chain needs to have its proper starting address so it knows which commands from the controller it has to decode. In the next section you will learn how to set the DMX addresses.

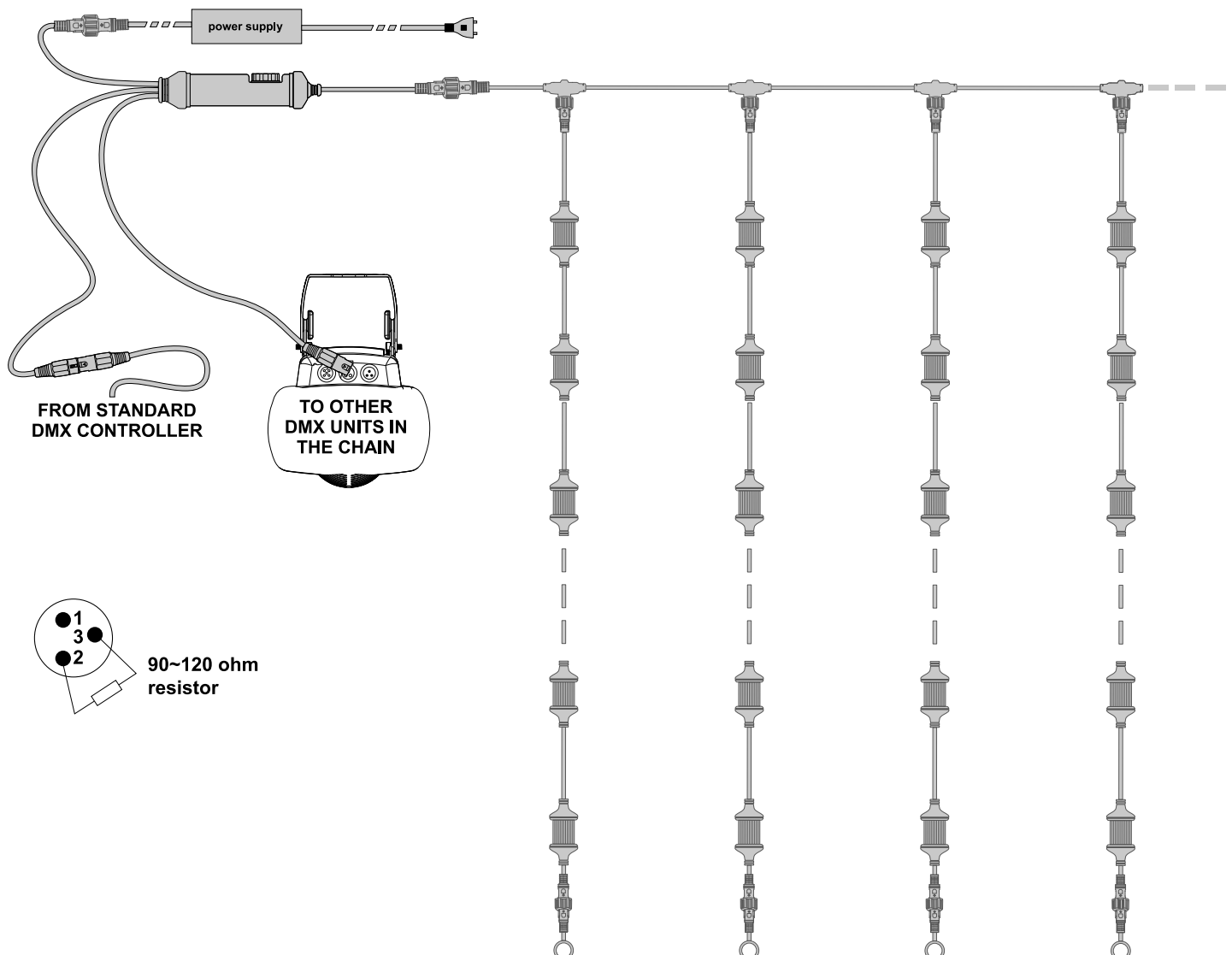

# How to set the DMX addresses:

## Setting individual DMX-addresses per LED String Controller (LS-RGB-DMX or LS-WH-DMX):

1. Connect the LED String Controller to universal DMX controller when universal DMX controller is off.
2. Connect the universal DMX controller & LED String Controller to the mains and switched on.
3. Set all DMX-channels on universal DMX controller to off (value000).
4. Set the DMX-channels of universal DMX controller, single channel or dual channel ;
  - Single channel: set the DMX-channels, that you want to assign as DMX-start address on your Smart DMX Controller, tot maximum (value 255).
  - Dual channel: set the two DMX-Channels, that you want to assign as DMX-start address on your LED String Controller, tot maximum (value 255).
5. Switch the "16-section" turntable (A) on the LED String Controller to any section from "1~F" (except "0") and then switch to "0", the LED indicator will glow.
6. When led indicator of LED String Controller glow (8 seconds), set the DMX-Channels of universal DMX controller from tot maximum (value 255) to off (value000) again. If dual channel, only one of them from tot maximum (value 255) to off (value000) will be okay.
7. LED indicator of LED String Controller will flash twice and off.
8. Done! DMX-channels of LED String Controller as shown in the DMX chart (refer to Figure 1).

**Figure1 LS-RGB-DMX DMX Chart**

CH1			
Function			
000 - 010	Blackout	121 - 130	Automatic program 12
011 - 020	Automatic program 1	131 - 140	Random playback of automatic programs 1~4
021 - 030	Automatic program 2	141 - 150	Random playback of all automatic programs
031 - 040	Automatic program 3	151 - 160	Automatic program 1
041 - 050	Automatic program 4	161 - 170	Automatic program 2
051 - 060	Automatic program 5	171 - 180	Automatic program 3
061 - 070	Automatic program 6	181 - 190	Automatic program 4
071 - 080	Automatic program 7	191 - 200	Automatic program 5
081 - 090	Automatic program 8	201 - 210	Automatic program 6
091 - 100	Automatic program 9	211 - 220	Automatic program 7
101 - 110	Automatic program 10	221 - 230	Automatic program 8
111 - 120	Automatic program 11	231 - 240	Automatic program 9
		241 - 255	Random playback of all sound programs

CH2	
Function	
000 - 255	Automatic program speed adjustment

**Figure1 LS-WH-DMX DMX Chart**

CH1			
Function			
000 - 010	Blackout	121 - 130	Automatic program 12
011 - 020	Automatic program 1	131 - 140	Automatic program 13
021 - 030	Automatic program 2	141 - 150	Random playback all automatic programs
031 - 040	Automatic program 3	151 - 160	Sound active program 1
041 - 050	Automatic program 4	161 - 170	Sound active program 2
051 - 060	Automatic program 5	171 - 180	Sound active program 3
061 - 070	Automatic program 6	181 - 190	Sound active program 4
071 - 080	Automatic program 7	191 - 200	Sound active program 5
081 - 090	Automatic program 8	201 - 210	Sound active program 6
091 - 100	Automatic program 9	211 - 220	Sound active program 7
101 - 110	Automatic program 10	221 - 230	Sound active program 8
111 - 120	Automatic program 11	231 - 240	Sound active mix ashing programs
		241 - 255	Random playback all sound programs

CH2	
Function	
000 - 255	Automatic program speed adjustment

**An example to make things clear:**

We will set the DMX start address of a LED String Controller to 113:

- Connect the LED String Controller to the DMX-controller as described above and make sure all is switched on.
- Set all DMX-channels on the controller to off (value000).
- Now set DMX-channel 113 to maximum (255).
- Switch the "16-section" turntable (A) on the LED String Controller to other section from 1~F (except"0") then back to "0" again and led indicator glow (8 seconds).
- Now set DMX-channel 113 to off (value000) again.
- Led indicator of LED String Controller will flash twice and off.
- Done! Your LED String Controller now has DMX address 113!

**Tips:**

1. If the led indicator only gives one flash and not lighted all the time (8 seconds), it means the following three possibilities:
  - A. The universal DMX controller is not connected to LED String Controller.

- B.** Address value of all channels on the universal DMX controller is 0.
  - C.** More than two channels have DMX address value of over 255.
2. Led indicator glowed means LED String Controller accepts the address for setting. Its status is waiting for confirmation. At S6, shifting the value from 255 to 0 means confirming the received address. If not confirmed in 8 seconds, the DMX setting will be suspended automatically.

## Operating instructions

1. Unscrew the plastic cover (1) and remove the rubber seal (2).
2. Use a small screwdriver to turn the program selector switch (3).
3. In both directions until the desired program is selected.
4. Put the rubber seal (2) in place and fasten the plastic cover (1) to against moisture and dust. The controller is IP44.

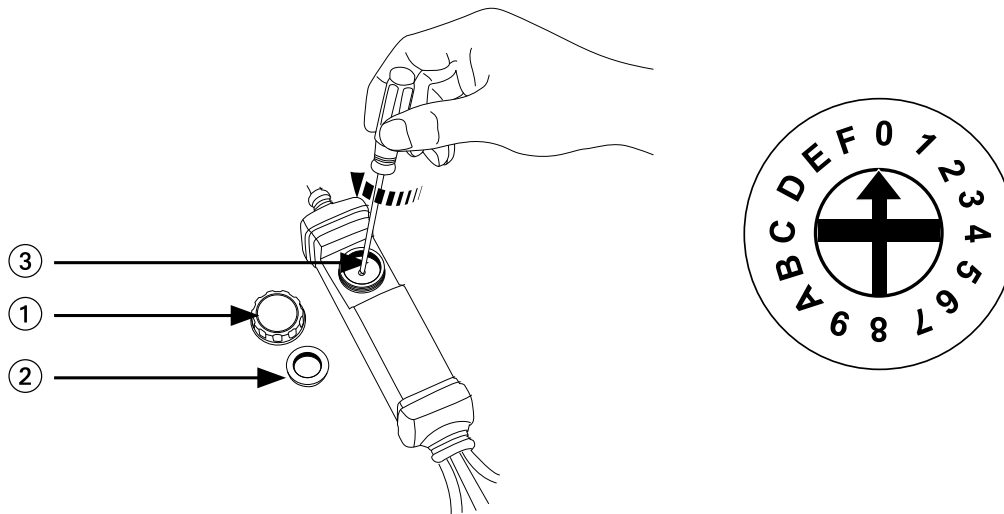

**Warning!** If use sound active program, please don't put the rubber seal (2) back and fasten the plastic cover (1) or controller can't receive the sound active. Under sound active program, the controller is without water-proof.



## 16-Section switch table - LS-RGB-DMX

No.	Speed	Function
0	Set up	DMX address preset
1	Mix program	Automatic program 1
2	Mix program	Automatic program 2
3	Mix program	Automatic program 3
4	Mix program	Automatic program 4
5	Mix program	Automatic program 5
6	Mix program	Automatic program 6
7	Mix program	Automatic program 7
8	Mix program	Automatic program 8
9	Mix program	Automatic program 9
A	Mix program	Automatic program 10
B	Mix program	Automatic program 11
C	Mix program	Automatic program 12
D	Slow	Random playback of all automatic programs 1~4
E	All	Random playback of all automatic programs
F	Sound active	Random playback of all sound active programs

## 16-Section switch table - LS-WH-DMX

No.	Speed	Function
0	Set up	DMX address preset
1	Mix program	Automatic program 1
2	Mix program	Automatic program 2
3	Mix program	Automatic program 3
4	Mix program	Automatic program 4
5	Mix program	Automatic program 5
6	Mix program	Automatic program 6
7	Mix program	Automatic program 7
8	Mix program	Automatic program 8
9	Mix program	Automatic program 9
A	Mix program	Automatic program 10
B	Mix program	Automatic program 10
C	Mix program	Automatic program 12
D	Mix program	Automatic program 13
E	Sound active 1	Mix flashing programs
F	Sound active 2	Random playback of all sound active programs

# Product Specifications

Item No.	LS-RGB-DMX	LS-WH-DMX
Output signal	SPI & DMX	SPI & DMX
Output Connector	5 pin JY & 3 pin XLR	5 pin JY & 3 pin XLR
Input Connector	2 pin DC 18V power	2 pin DC 18V power
DMX Channel	2CH	2CH
Connector IP	IP44	IP44
Built-in Programs	14 automatic + 1 sound active programs + 1 DMX Setting	13 automatic + 2 sound active programs + 1 DMX Setting
Maximum Load (signal)	200 units of RGB	1024 units of WH
Maximum Load (power)	50 units of RGB.	50~80 units of WH.
Input Power	External power supply DC 18V/3A	External power supply DC 18V/3A
Voltage	120V 60Hz or 230V 50Hz	120V 60Hz or 230V 50Hz
Fuse	N/A	N/A
Dimension (LxW)	193 x 47mm	193 x 47mm
Weight	0.33KG	0.33KG

\*Above Dimension & Weight is not including additional power supply.

Save this instruction properly  
Every information is subject to change without prior notice

**WWW.BEGLEC.COM**

**Copyright © 2011 by BEGLEC NV**

't Hofveld 2C ~ B1702 Groot-Bijgaarden ~ Belgium

Reproduction or publication of the content in any manner, without express permission of the publisher, is prohibited.